

PLAN REFERRED TO
IN DECISION NOTICE DATED
09 OCT 2013
W.S.C.C.

W.S.C.C.
- 3 JUN 2013
COUNTY PLANNING

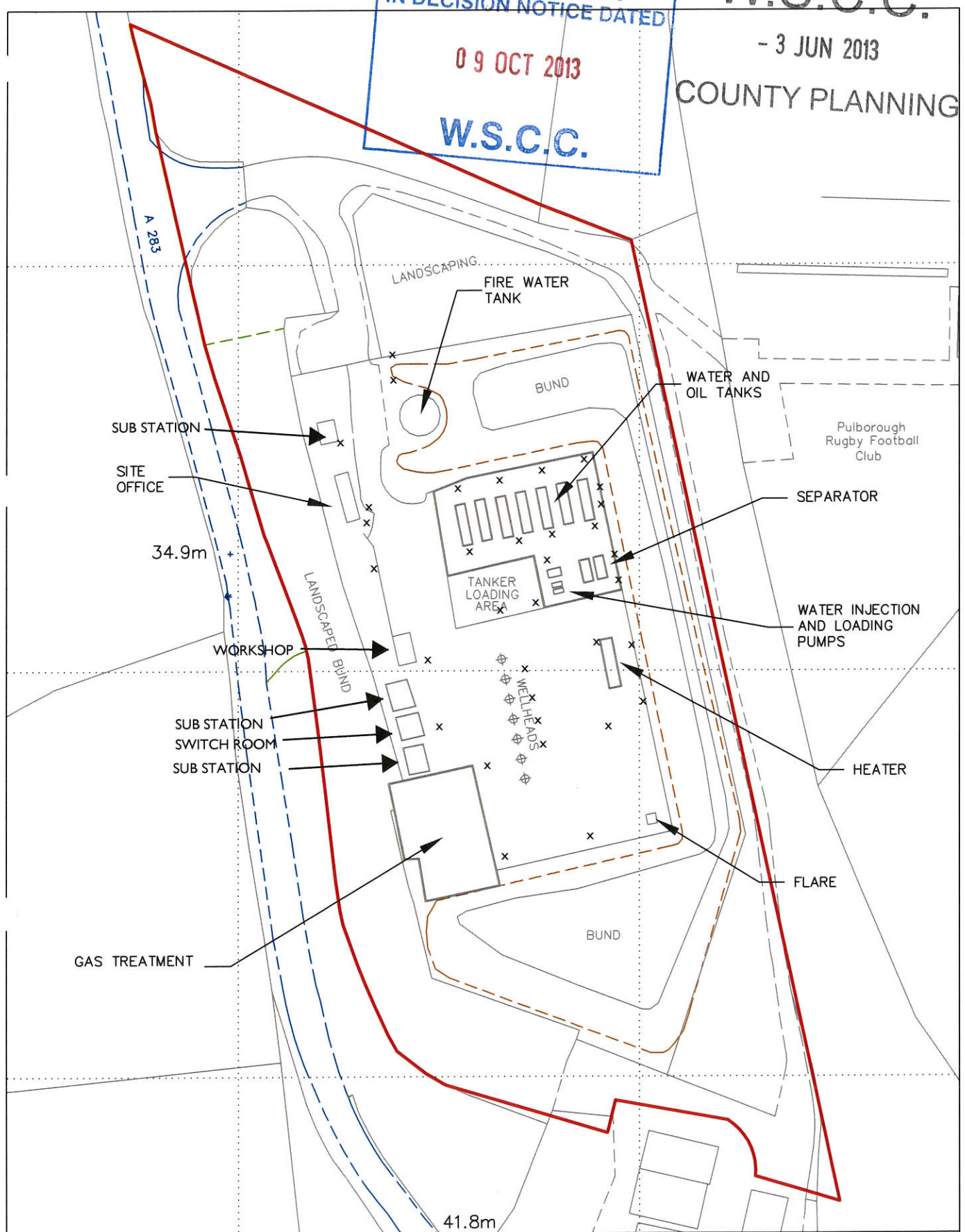

NOTES:
x - Light

STORRINGTON WELL SITE
LIGHTING PLAN

SCALE: 1:1,250 @ A4	NGR: TQ 068 149
DATE: 08/05/2013	REF: STO-03A
<small>Reproduced from Ordnance Survey material. Crown Copyright. All rights reserved. Licence number 100020449.</small>	



PLAN REFERRED TO
IN DECISION NOTICE DATED

09 OCT 2013

W.S.C.C.

W.S.C.C.

- 3 JUN 2013

COUNTY PLANNING

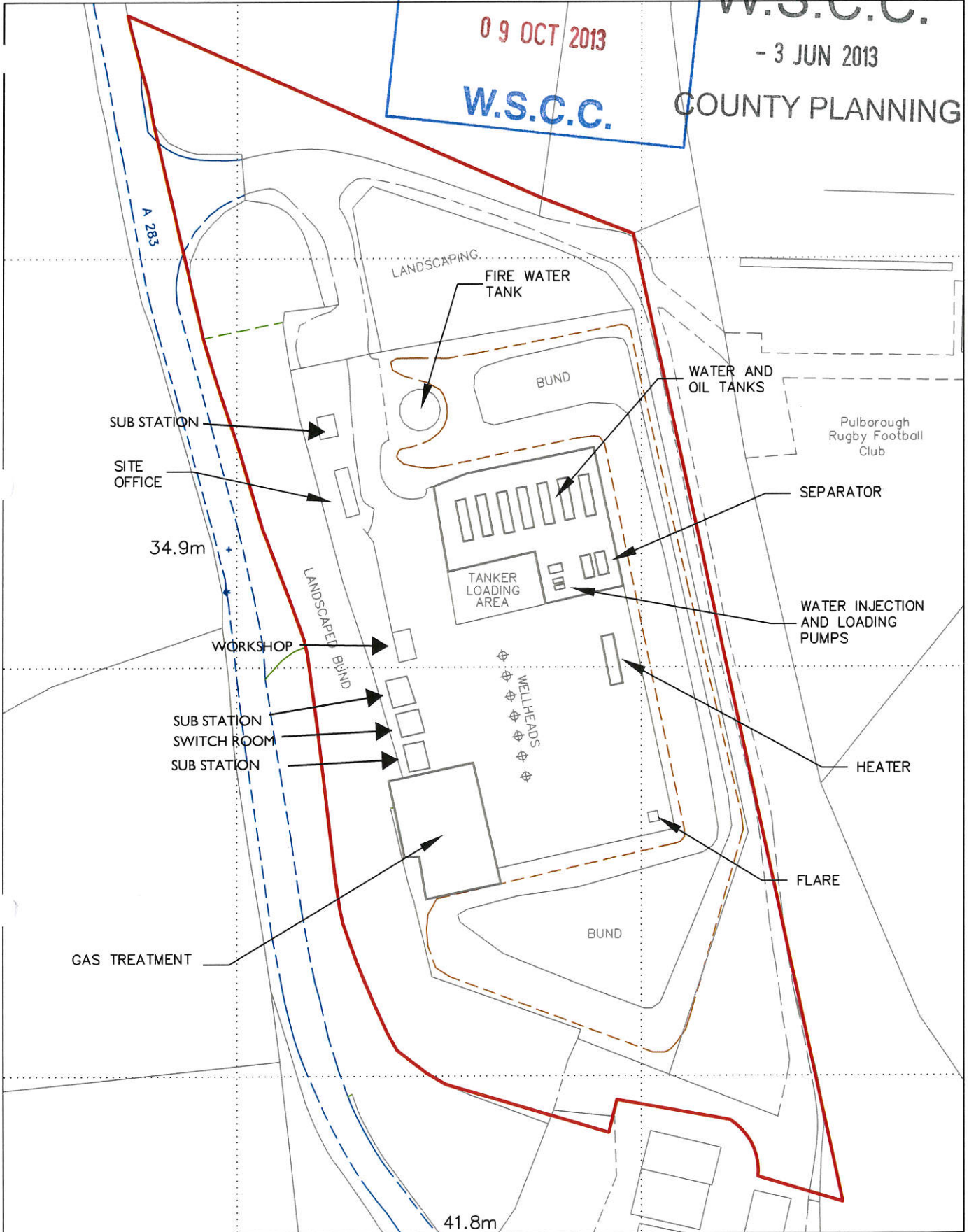

NOTES:

STORRINGTON WELL SITE
SITE PLAN

SCALE: 1:1,250 @ A4

NGR: TQ 068 149

DATE: 08/05/2013

REF: STO-01C

Reproduced from Ordnance Survey material. Crown Copyright.
All rights reserved. Licence number 100020449.



