

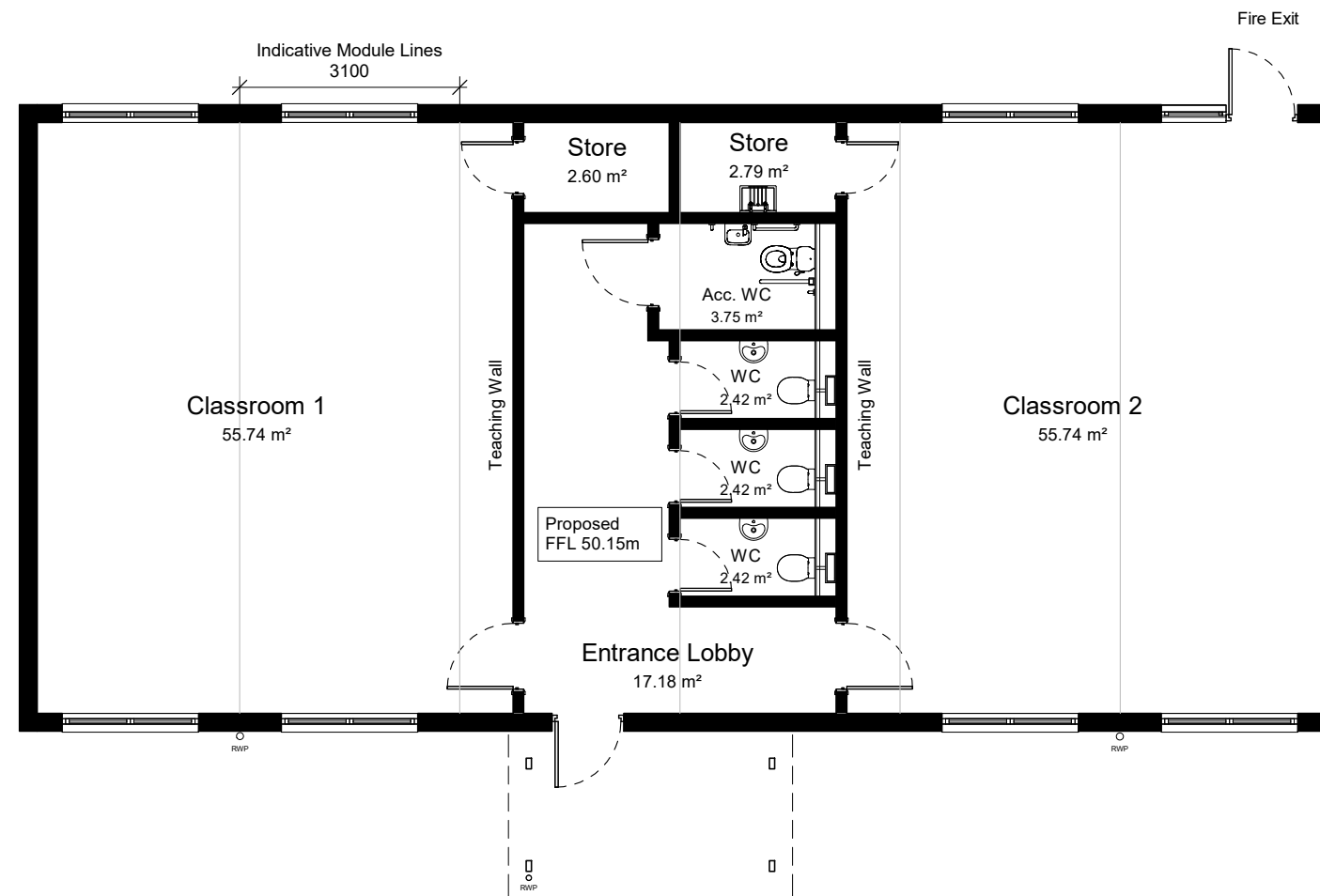

This drawing is the copyright of HNW Architects Ltd Registered No. 3689904  
 All dimensions must be verified on site prior to construction.  
 Do not scale this drawing except for Planning Application purposes.  
 Ordnance Survey Licence No. 100030200  
 Only PDF issues of this drawing are controlled. All other formats of this drawing (e.g. dwg Autocad or .dxf files) are uncontrolled and are used at your own risk.  
 This drawing must not be copied, transmitted or passed to a third party, without written consent

Rev	Amendments	By	Chkd	Date
P01	Issued for Planning	NC	DS	09/03/23



**Proposed Floor Plan**  
 1 : 100

**Note:**  
 This drawing is to be read in conjunction with all relevant Architectural, Structural, Civil, MEP, Landscape Architect and Specialist Subcontractor drawings, specifications, schedules and information.

**Note WIP:**  
 This drawing is subject to further coordination. Resultant amendments may be necessary following receipt and coordination of Consultant/ Building Control/ Fire/ Acoustic Engineer and Subcontractor/ Supplier Information.

**Design Intent:**  
 This drawing illustrates design intent only. Design Development to be undertaken by Contractor to ensure compliance with all relevant guidance documents noted and to include Manufacturer and/or Specialist Subcontractor's Detailed Design and Specification where required.

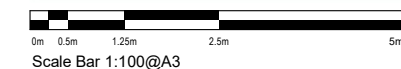

Project			
WSSC Downlands School, Hassocks Proposed Modular Classrooms			
Drawn by	Checked by	HNW Project No.	Date Created
NC	DS	22048	MAR 2023
Scale			
A3- 1 : 100			
Drawing Title			
Proposed Floor Plan			
Drawing status		Revision	
Planning		P01	
Drawing Name			
22048-HNW-ZZ-00-DR-A-2200			
61 North Street, Chichester, West Sussex, PO19 1JH			

