

## Elevations

Scale 1:100

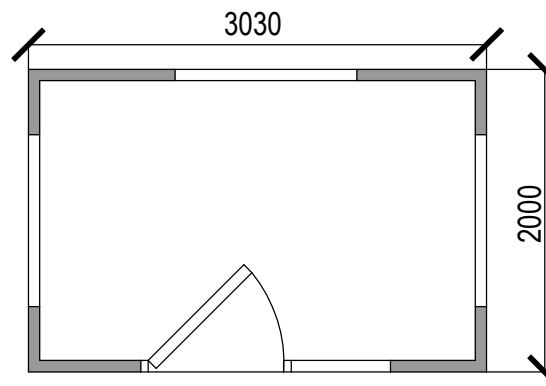
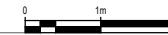

## Cabin Plan

Scale 1:50



BROADGATE TOWER, 8TH FLOOR, PRIMROSE STREET, LONDON, EC2A 2EW

THIS DOCUMENT IS THE PROPERTY OF UKOG (234) LTD. IT CONTAINS PROPRIETARY AND CONFIDENTIAL INFORMATION WHICH MUST NOT BE DUPLICATED, USED OR DISCLOSED OTHER THAN AS EXPRESSLY AUTHORISED BY UKOG (234) LTD OR ITS REPRESENTATIVE © 2021

### REVISION HISTORY

REV	DATE	BY	DETAILS	APR
-	-	-	-	-
2	NOV21	JF	RE-ISSUE	JF
1	NOV19	JF	RE-ISSUE	JF
0	MAY18	JF	ORIGINAL ISSUE	JF

SITE: BROADFORD BRIDGE

PROJECT: BROADFORD BRIDGE,  
WEST SUSSEX

TITLE: EXISTING ENTRANCE SECURITY  
CABINS - LAYOUT PLAN &  
SECTIONS

CLIENT: UKOG (234) LTD

Scale: 1:100

Size: A4

Sheet: 1 of 1

DWG. No:

KOGL-BB-PA-YY-08