

This drawing is the copyright of AXIS P.E.D Limited and may not be loaned, copied or reproduced in any way - or used for any offer, quote, tender or construction purposes without written consent of the company to do so

Follow any figured dimensions - do not scale for construction purposes. IF IN DOUBT ASK.

| Revision History | | Date |
|------------------|--------------|----------|
| A | FOR PLANNING | 14/07/21 |

- KEY:
- Site Boundary
 - Indicative Existing Vegetation
 - Former Canal
 - 1.5m Lowered Area
 - Retaining Wall
 - Wooden Acoustic Fencing
 - Paladin Fencing
 - 1.1m Guard Rail
 - Gabion Wall Knapped Flint Finish
 - Pastel Blue herringbone hatch block paving surfacing to indicate former Canal Alignment
 - Impermeable Concrete
 - Impermeable asphalt
 - Permeable asphalt
 - Benches
 - Proposed Contours
 - Proposed Spot Heights
 - Sloped Landform
 - Pond

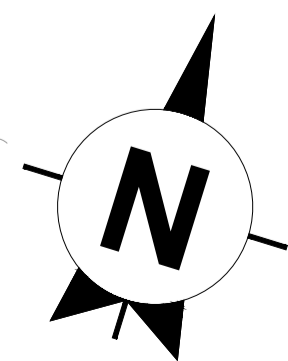
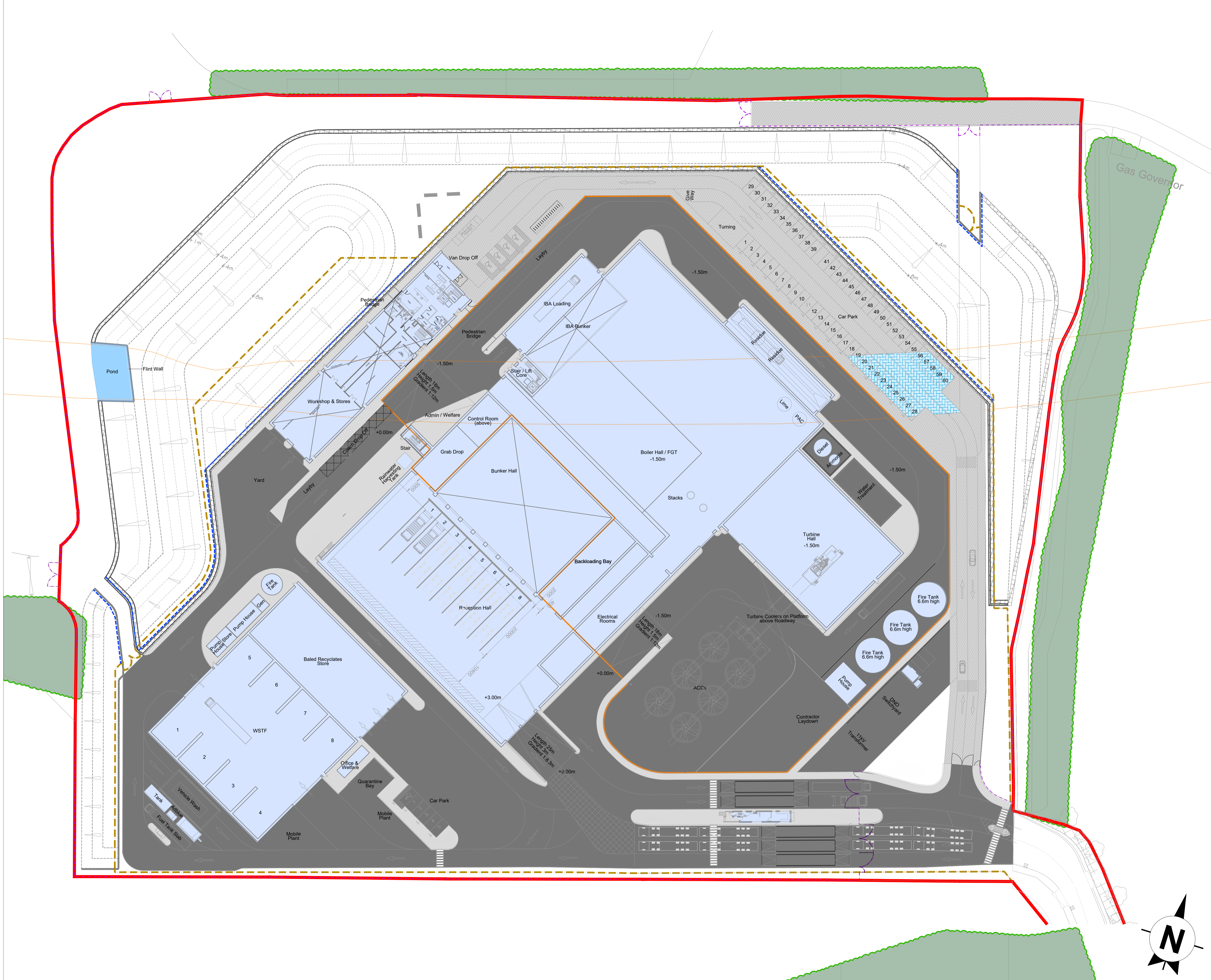

| | | |
|---|---|-------------|
| Chester Office: Well House House Breton Chester CH4 9DH | South Manchester Office: Canalside House 76 Water Lane Wilmslow SK9 5BB | |
| 0844 8700 007 - www.axisped.co.uk | | |
| client: --- | | |
| project: FORD CIRCULAR TECHNOLOGY PARK | | |
| drawing title: LANDSCAPE HARDWORKS General Arrangement | | |
| date: 14.07.21 | drawn by: PHM | checked: JM |
| drawing number: 2829-01-004 | status: FOR PLANNING | |
| scale(s): 1:500 @ A1 | rev: A | |
| planning environment design | | |