

- NOTES:
- ALL DIMENSIONS ARE IN METRES UNLESS NOTED OTHERWISE.
  - FOR FULL DETAILS OF HIGHWAY LAYOUT SEE DRAWING Nos. A29-CAP-HPN-00-DR-C-0132 to 0136.
- KEY (PLAN):
- CENTRELINE WITH CHAINAGE IN METRES
  - ENGINEERING EARTHWORKS
  - TREE
- KEY (PROFILE):
- EXISTING GROUND LEVEL
  - PROPOSED GROUND LEVEL
  - ROUNDABOUT PROFILE
- R RADIUS  
L LENGTH  
G GRADIENT  
K K VALUE

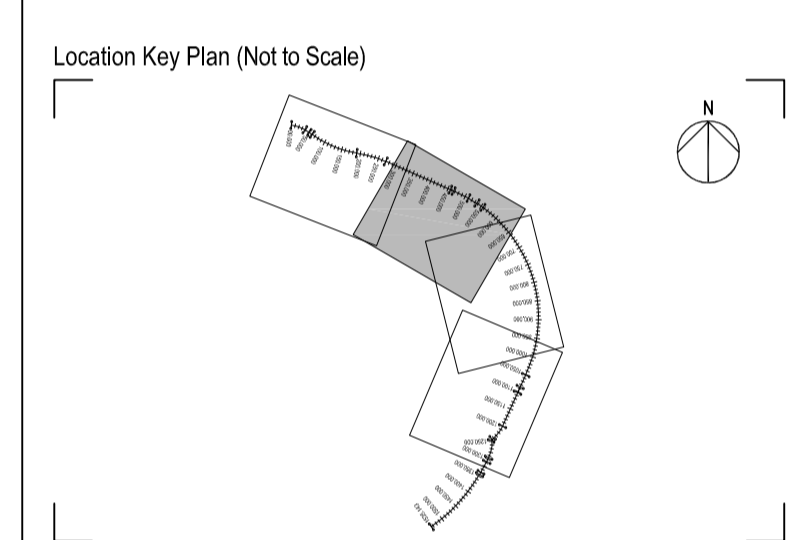

| Rev | Drawn | Checked | App'd | Description                   | Date     |
|-----|-------|---------|-------|-------------------------------|----------|
| P05 | KS    | KS      | AB    | WEST BOUND BUS STOP RELOCATED | 29.03.22 |
| P04 | JD    | KS      | AB    | HIGHWAY LAYOUT UPDATED        | 08.04.21 |
| P03 | CS    | KS      | AB    | HIGHWAY LAYOUT UPDATED        | 16.12.20 |
| P02 | JPC   | KS      | AB    | NOTES ADDED AND KEY UPDATED   | 28.08.20 |
| P01 | JPC   | DAH     | KS    | FIRST ISSUE                   | 03.07.20 |

Purpose of Issue: For Planning  
Classification: S0  
Public  
Client: west sussex county council, Jackson  
Project: A29 Realignment Scheme  
Drawing: A29 Link Road Plan and Profile Sheet 2 of 4  
Scale @ A1: AS SHOWN, Drawn: JPC, Checked: DAH, Approved: KS  
Project No: CS099505, Date: 03.07.20  
Drawing Identifier: A29-CAP-HPN-00-DR-C-0176, Revision: P05

**CAPITA**  
Capita House, Wood Street, East Grinstead, RH19 1UU  
01342 327161  
www.capitaproperty.co.uk  
Capita Property and Infrastructure Ltd.

Print Date: 29/03/2022 16:11:51