

GAP BETWEEN TWO SUPPLIED RESTORATION PDFS

EXISTING RESTORED GRASSLAND, MANAGED FOR GRAZING OR MOWN FOR HAY

SHRUB SCRUB PLANTING TO SIDES OF FOOTPATH TRACK TO PREVENT ACCESS TO RESTORED FACES

LAKE Final Water Level 42.0m AOD Max

PROMONTORY CREATED WITH REJECT MATERIALS AND STRIPPED SOILS

LAKESIDE FOOTPATH SET ON SPECIALLY DESIGNED BENCH AT LEVEL 43.0m AOD

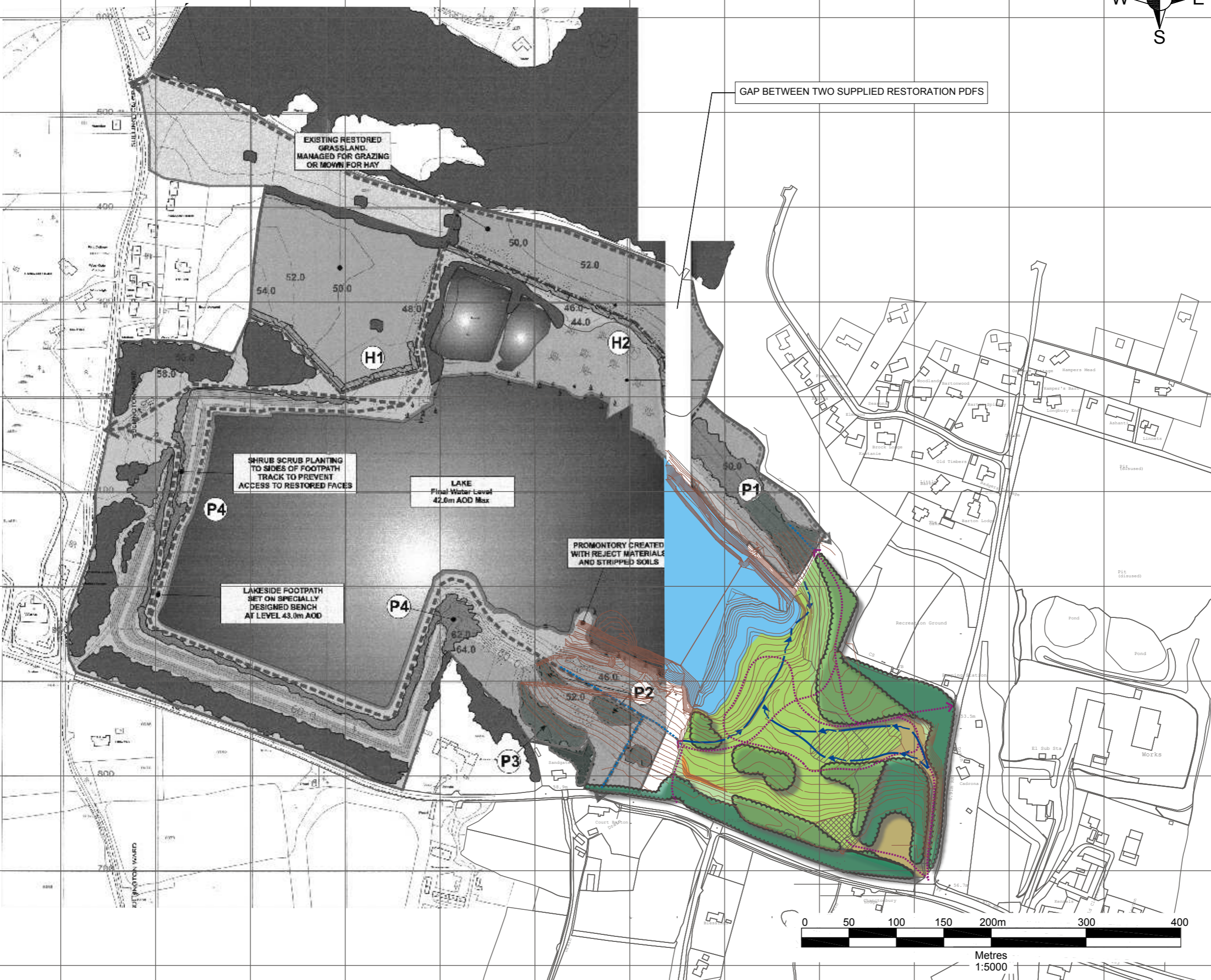

**NOTES**

DESIGN FOR PLANNING PURPOSES ONLY. NOT TO BE RELIED UPON FOR CONSTRUCTION PURPOSES.

SITE DESIGN SEEKS BALANCE BETWEEN PUBLIC ACCESS AND NATURE CONSERVATION, SUPPORTING LINKS TO THE WIDER COUNTRY PARK AND INFORMAL RECREATIONAL ACTIVITIES IN LINE WITH HORSHAM DISTRICT COUNCIL LDF POLICY AL 19. REFER TO SUPPORTING LANDSCAPE RESTORATION MANAGEMENT PLAN FOR FURTHER DETAILS.

SWALE LOCATIONS ARE INDICATIVE ONLY. SHOULD FURTHER WATER ATTENUATION BE REQUIRED THEN THERE IS SUFFICIENT SCOPE WITHIN THE DESIGN TO SUPPORT A SMALL POND AT THE SOUTH EASTERN EDGE OF THE POTENTIAL CAMPSITE AREA. DETAILS TO BE AGREED.

- LEGEND**
- PROPOSED CONTOURS (1M INTERVALS)
  - EXISTING SANDSTONE FACES TO BE RETAINED (VALUABLE SAND MARTIN AND INSECT HABITAT)
  - EXISTING WOODLAND/TREES TO BE RETAINED
  - PROPOSED CEMEX RESTORATION PLANTING
  - PROPOSED NATIVE BROADLEAVED WOODLAND PLANTING
  - PROPOSED ACID GRASSLAND / HEATHLAND
  - PROPOSED SCRUB REGENERATION
  - PROPOSED WATERBODY
  - POTENTIAL COURSE OF SWALES
  - POTENTIAL PERMISSIVE FOOTPATH
  - POTENTIAL FOOTPATHS ON CEMEX SITE
  - PROPOSED CAR PARKING AREA (BARE CONSOLIDATED GRAVEL/SAND)



**SLR**

19 HOLLINGWORTH COURT  
TURKEY MILL  
MAIDSTONE  
KENT, ME14 5PP  
T: 01622 609242  
F: 01622 695872  
www.slrconsulting.com

WASHINGTON SANDPIT

**SANDGATE RESTORATION SCHEME**

**WP L/20**

Scale 1:4000 @ A3      Date 14/05/2014