

NOTE :-
 DO NOT SCALE FROM THIS DRAWING.
 ALL DIMENSIONS RELATING TO SUBCONTRACTORS OR SUPPLIERS WORK MUST BE CHECKED AND AGREED BETWEEN THE GENERAL CONTRACTOR AND THE SUBCONTRACTORS AND SUPPLIERS.
 ALL DIMENSIONS ARE IN MILLIMETRES. IF IN DOUBT ASK.
 THIS DRAWING MAY BE SCALED FOR PLANNING PURPOSES ONLY.
 ALL WORKS OR MATERIALS INDICATED ON THE DRAWING ARE TO BE TO THE LATEST BRITISH STANDARDS AND ARE TO BE CARRIED OUT IN ACCORDANCE WITH THE RELEVANT CODES OF PRACTICE OR RECOGNISED TRADE ASSOCIATION RECOMMENDATIONS AND PUBLICATIONS.
 © THIS DRAWING IS THE COPYRIGHT OF NASH AND PARTNERS LTD.

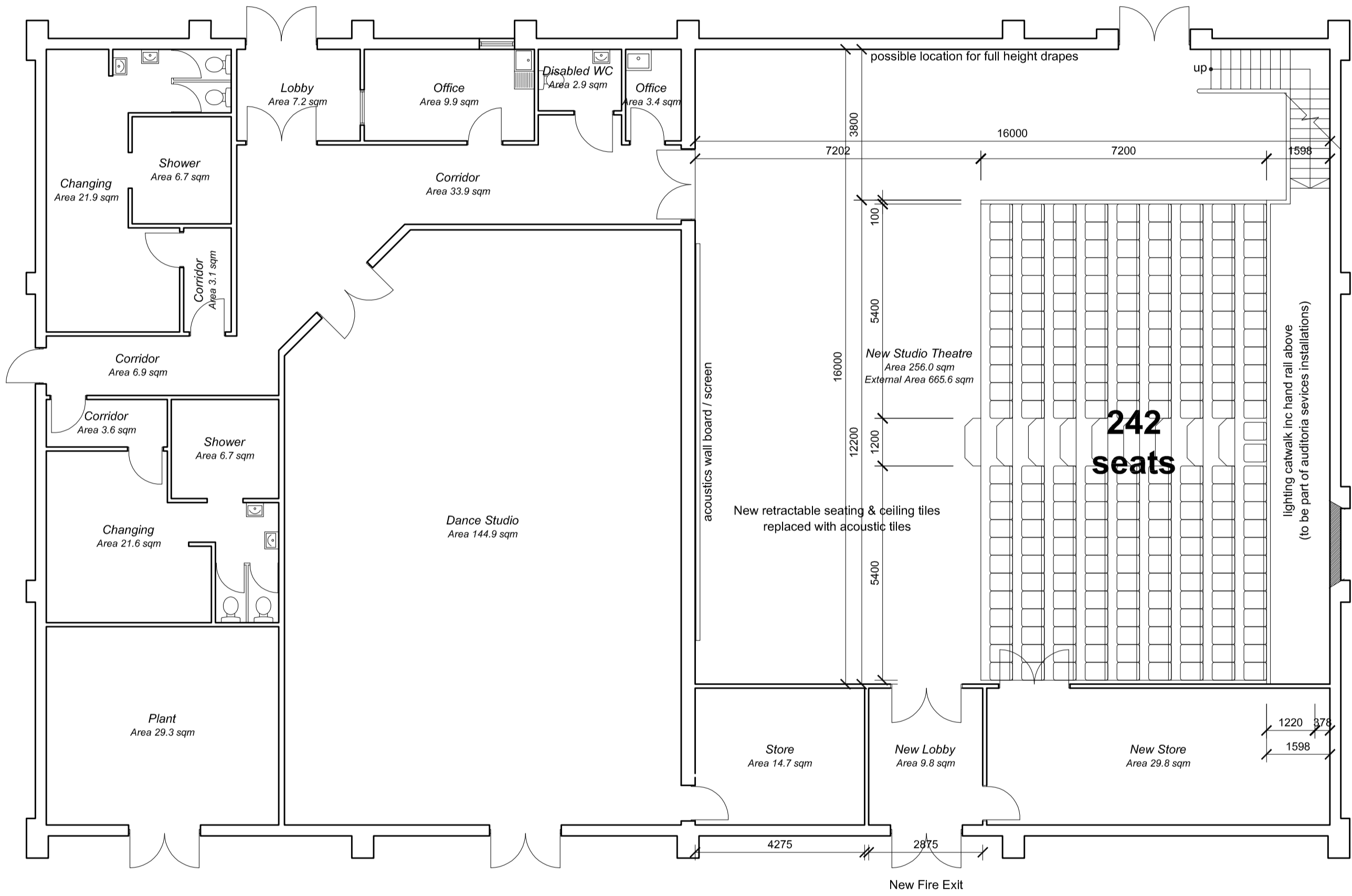

PROPOSED GROUND FLOOR PLAN
 SCALE 1:100

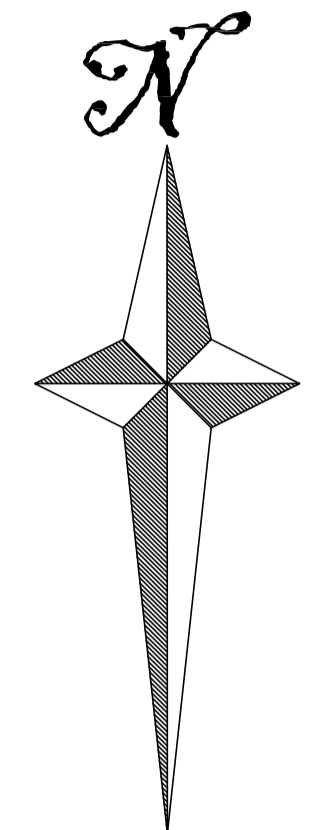
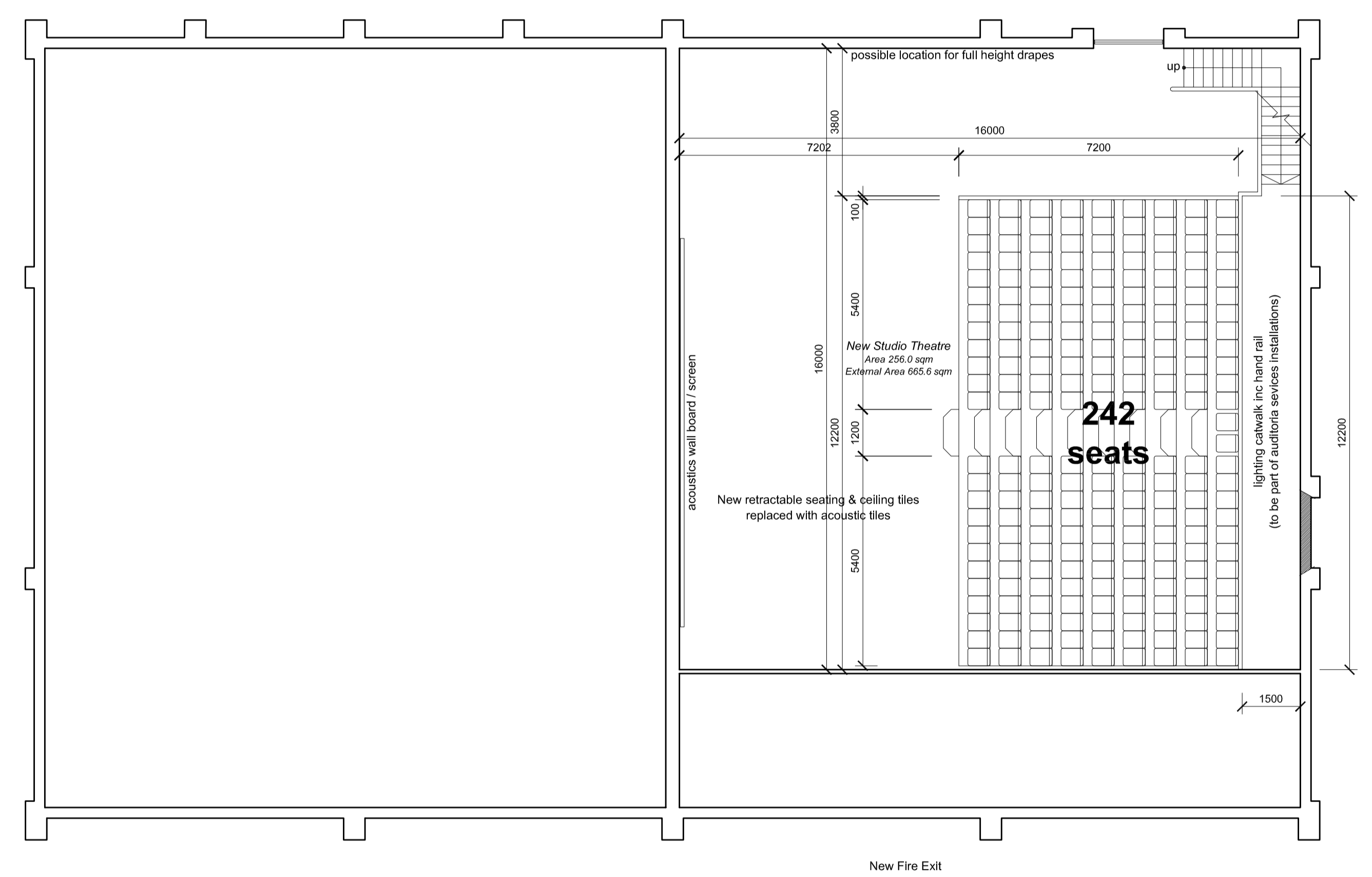

PROPOSED FIRST FLOOR PLAN
 SCALE 1:100

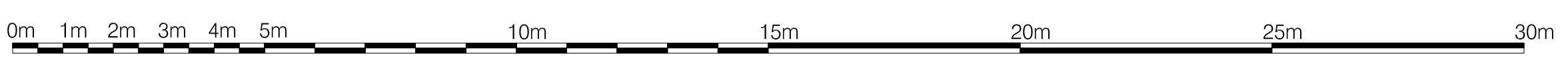

Scale Bar 1:100

Rev	Date	By	Description
B	02-05-08	CC	Layout amended
A	24-04-08	CC	Layout Amended
#	08-04-08	CC	Drawing first issued.

LOCATION: Chichester High School for Girls, Kingsham Road, Chichester, West Sussex, PO19 8EB.

DRAWING: Proposed Extension Works, Proposed Gymnasium Plans.

Date: 08-04-08 Drawn By: C.C.

Scale: 1:100 @ A1

Drawing No: 1104/BS-101 Revision: B

NASH & PARTNERS LIMITED
 Station Approach Southgate Chichester
 West Sussex PO19 8QA
 Tel +44 (0) 1243 815720 Fax +44 (0) 1243 784419
 Email office@nashandpartners.com www.nashandpartners.com

NASH

- ARCHITECTS
- SURVEYORS
- PROJECT MANAGERS
- PROPERTY CONSULTANTS

CAD file name